



Application C835575 WESTERN



AUSTRALIA



Volume 1672 Folio 364

1672 371

CERTIFICATE OF TITLE

UNDER THE "TRANSFER OF LAND ACT, 1893" AS AMENDED

I certify that the person described in the First Schedule hereto is the registered proprietor of the undermentioned estate in the undermentioned land subject to the easements and encumbrances shown in the Second Schedule hereto.

N.J. Smyth



REGISTRAR OF TITLES

Dated 14th August, 1984

ESTATE AND LAND REFERRED TO

Estate in fee simple in portion of Perthshire Location 101 and being Lot 425 on Plan 14662, delineated and coloured green on the map in the Third Schedule hereto.

FIRST SCHEDULE (continued overleaf)

~~Maytime Pty. Ltd., of Second Floor, 10 Outram Street, West Perth.~~

SECOND SCHEDULE (continued overleaf)

1. MORTGAGE C742198 to ~~A.G.C. (General Finance) Ltd.~~ Registered 2.4.84 at 3.17 o/c.
Discharged D113911 20.9.85

N.J. Smyth

REGISTRAR OF TITLES

THIRD SCHEDULE

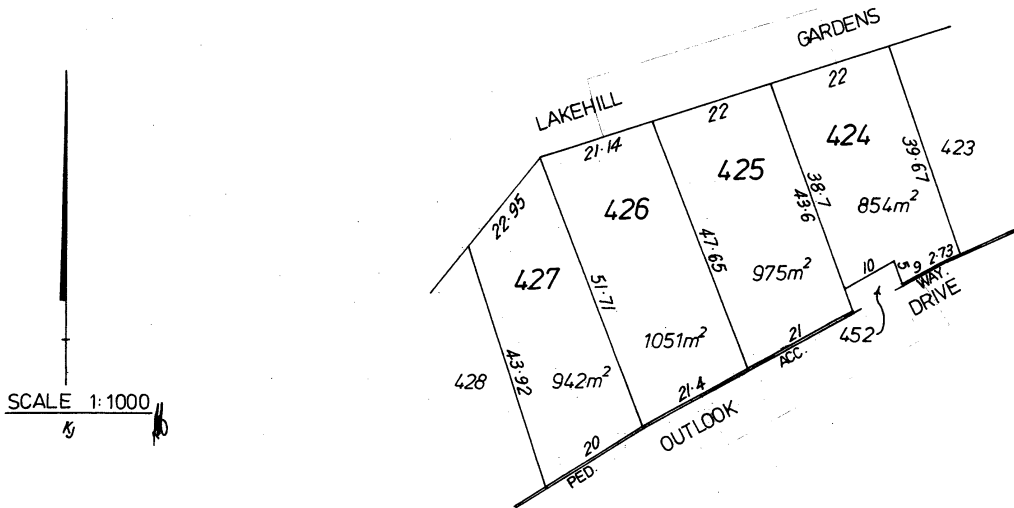

NOTE: RULING THROUGH AND SEALING WITH THE OFFICE SEAL INDICATES THAT AN ENTRY NO LONGER HAS EFFECT. ENTRIES NOT RULED THROUGH MAY BE AFFECTED BY SUBSEQUENT ENDORSEMENTS.

72009/12/77-45M-S/2860

Superseded - Copy for Sketch Only

PERSONS ARE CAUTIONED AGAINST ALTERING OR ADDING TO THIS CERTIFICATE OR ANY NOTIFICATION HEREON

FIRST SCHEDULE (continued)

NOTE: RULING THROUGH AND SEALING WITH THE OFFICE SEAL INDICATES THAT AN ENTRY NO LONGER HAS EFFECT.
ENTRIES NOT RULED THROUGH MAY BE AFFECTED BY SUBSEQUENT ENDORSEMENTS.

REGISTERED PROPRIETOR	INSTRUMENT		REGISTERED	TIME	SEAL	INITIALS
	NATURE	NUMBER				
<u>James Kenneth Graham</u> , of 18B Hollett Road, Morley, Builder.	Transfer	D113912	20.9.85	2.39		
David Ross Francis, Bus Driver and Glenise Lorraine Francis, Married Woman, both of 34 Fenellia Crescent, Craigie, as joint tenants.	Transfer	D275510	30.6.86	1.41		
David Ross Francis and Johanna Riniskie Hatherley both of 23 Lakehill Gardens Edgewater	Transfer	F9521	9.10.92	15.32		
Ronald Andre Visser and Donna Hilda Visser both of 23 Lakehill Gardens, Edgewater.	Transfer	F911935	27.6.95	8.20		

SECOND SCHEDULE (continued)

NOTE: RULING THROUGH AND SEALING WITH THE OFFICE SEAL INDICATES THAT AN ENTRY NO LONGER HAS EFFECT.
ENTRIES NOT RULED THROUGH MAY BE AFFECTED BY SUBSEQUENT ENDORSEMENTS.

INSTRUMENT	PARTICULARS	REGISTERED	TIME	SEAL	INITIALS	CANCELLATION	NUMBER	REGISTERED OR LODGED	SEAL	INITIALS
Transfer	Contains a restrictive covenant	20.9.85	2.39			Discharged	E412538	27.7.90		
Mortgage	to Westbond Credit Union Ltd.	30.6.86	1.41			Discharged	F9520	9.10.92		
Mortgage	to Challenge Bank Ltd	27.7.90	9.42			Discharged	F597064	30.6.94		
Mortgage	to Challenge Bank Ltd	9.10.92	15.32			Discharged	F911934	27.6.95		
Mortgage	to National Australia Bank Ltd.	30.6.94	8.50							
Mortgage	to Westpac Banking Corporation.	27.6.95	8.20							